

Catalog Lanturi 2010

www.agro-tehnica.md mobil: 060187542 email: cabacom.cad@gmail.com

Adresa: Republica Moldova , Chisinau , sos. Muncesti 56

Cuprins catalog:

Pagina:

1. CUPRINS
2. 38.4
3. 38.4
4. S32
5. S42
6. S45
7. S51
8. S52
9. S55
10. S55R/S55J
11. S55/S62
12. S62/S77
13. S77/S78
14. S88/CA550
15. CA550
16. CA555/CA557
17. CA557/CA2801
18. CA2801/CA2060
19. CA2060 216BF/208A...212
20. 210B 212B 04B2-56B2
21. 06B3-56B3
22. CA2801 CA645/646-624/643/414
23. S62R CA620 CL555



CATALOG LANTURI

38,4

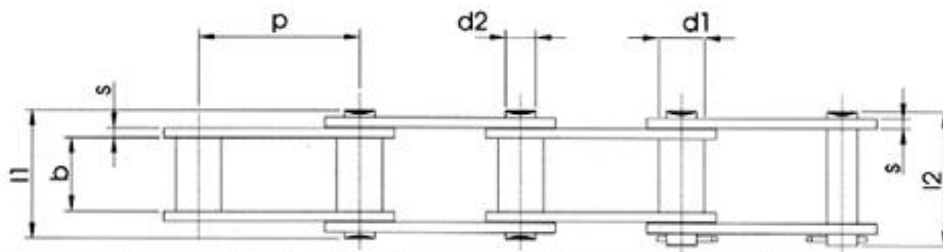
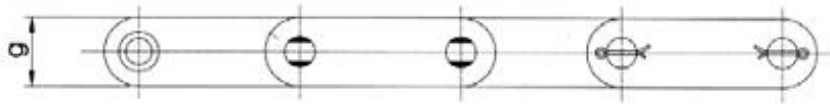

MODEL	p	b (min)	d1 (max)	d2	s	g	l1	l2
38,4R	38,40	19,05	15,88	6,92	2,39	17,00	33,70	37,4
38,4V	38,40	18,00	15,88	6,92	2,90	17,00	34,80	38,75
38,4VB	38,40	19,05	15,88	8,26	2,90	20,10	35,70	39,75

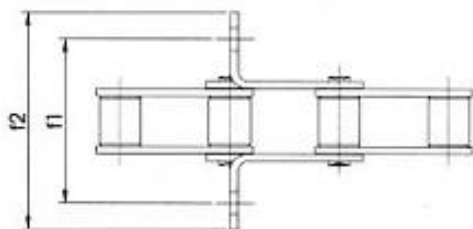
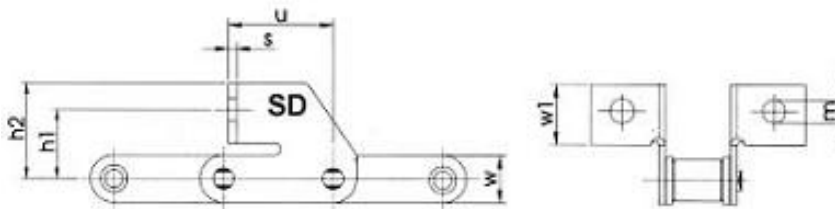
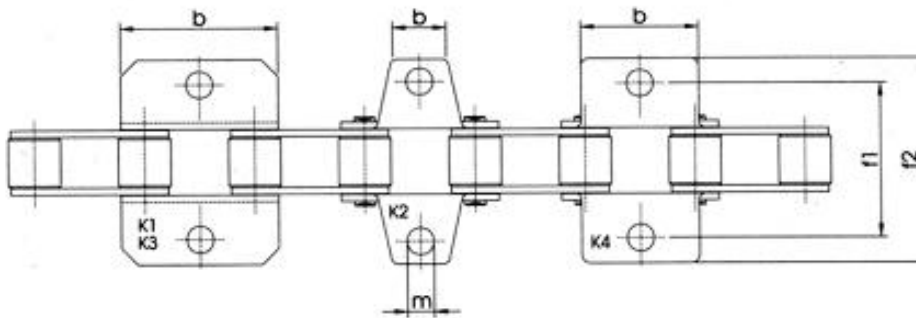
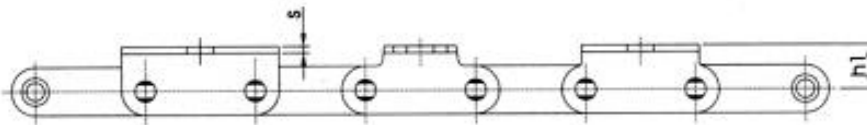

MODEL	TYP TYPE	s	m	b	u	h1	h2	f1	f2 (max)	W1 ^{SD}	W
38,4R	K1	2,39	8,50	61,50	-	15,10	-	58,00	76,50	-	17,00
	K2	2,39	9,20	20,00	-	15,40	-	58,00	80,50	-	17,00
	K3	2,39	10,50	61,50	-	15,10	-	58,00	76,50	-	17,00
	K4	2,39	8,50	47,00	-	11,20	-	58,00	77,00	-	17,00
	SD	2,39	8,40	-	32,00	24,00	34,50	52,00	70,00	21,00	17,00
38,4V	K1	2,39	8,50	61,50	-	15,10	-	57,00	75,00	-	17,00
	K2	2,90	9,03	20,00	-	15,40	-	57,00	81,50	-	17,00
	K3	2,90	10,55	61,50	-	15,10	-	57,00	75,00	-	17,00
	K4	2,90	8,50	47,00	-	11,20	-	57,00	77,00	-	17,00
	SD	2,90	8,40	-	32,00	24,00	34,50	52,00	70,00	21,00	17,00
38,4VB	K1	2,90	10,55	61,50	-	14,00	-	-	87,00	-	20,10
	SD	2,90	8,40	-	38,00	24,00	36,75	52,00	70,00	21,70	20,10

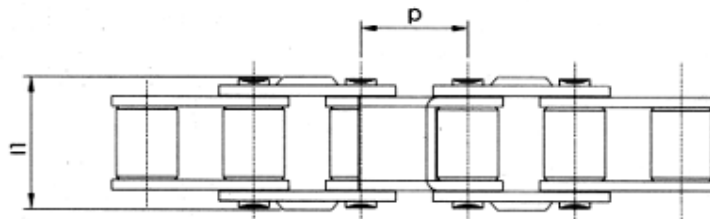
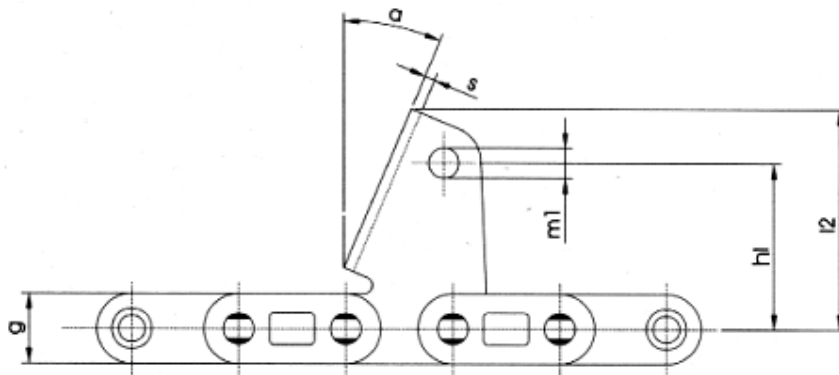

MODEL	P	s	a	g	m1	l1	l2	h1
38,4VB	38,40	2,90	22,5°	20,10	8,10	37,00	66,50	49,00

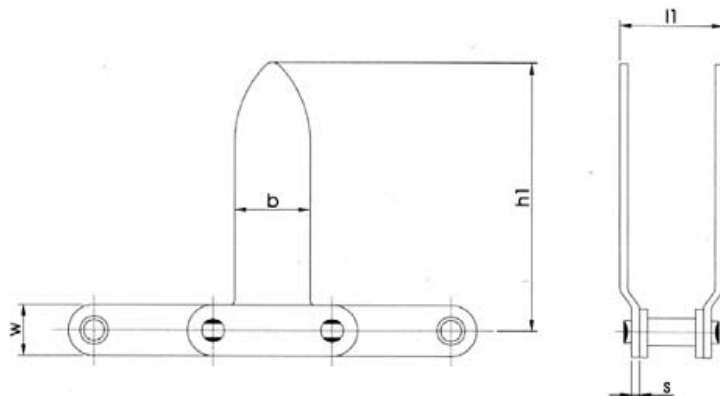

MODEL	TYP TYPE	s	b	l1 (max)	h1	w
38,4VB	HB4	2,90	22,5°	20,10	8,10	37,00

S32

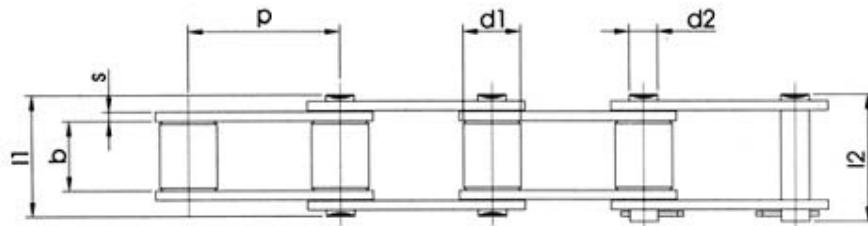
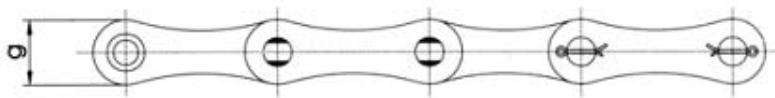

MODEL	p	b (min)	d1 (max)	d2	g	s	l1	l2
S32H	29,21	15,88	11,43	5,07	13,00	2,00	26,60	28,40

S32H ATTACHMENT CHAIN

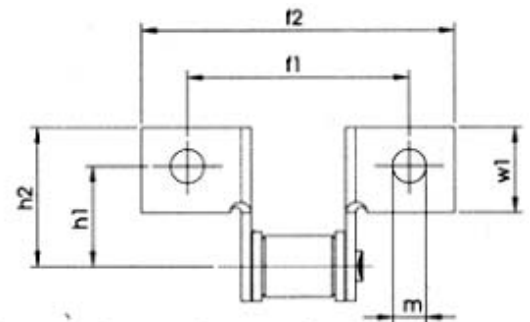
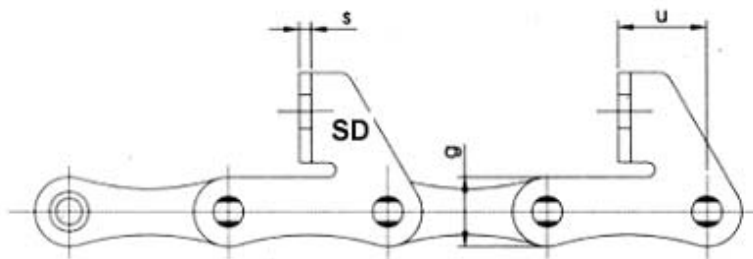
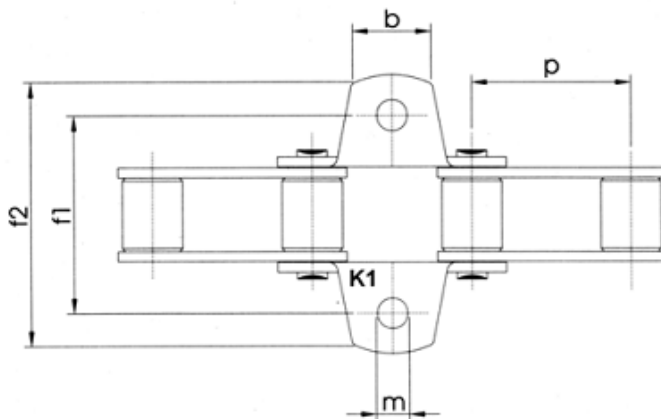
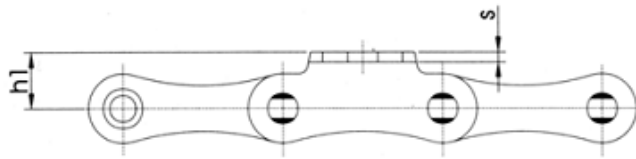

MODEL	TYP TYPE	p	s	g	m	b	h1	h2	f1	f2	u
S32H	K1	29,21	1,65	13,00	5,30	20,00	8,70	-	42,90	60,50	-
S32H	SD	29,21	1,65	13,00	5,30	-	20,00	29,50	58,00	78,00	19,00

S42

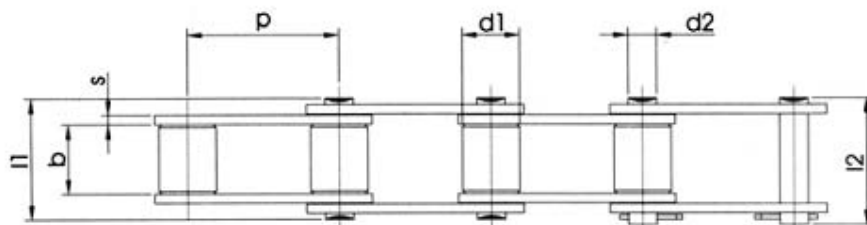
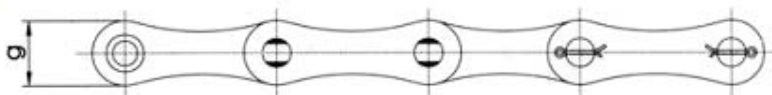

MODEL	p	b (min)	d1 (max)	d2	g	s	l1	l2
S42	34,93	19,05	14,27	7,00	19,60	2,60	34,25	36,70

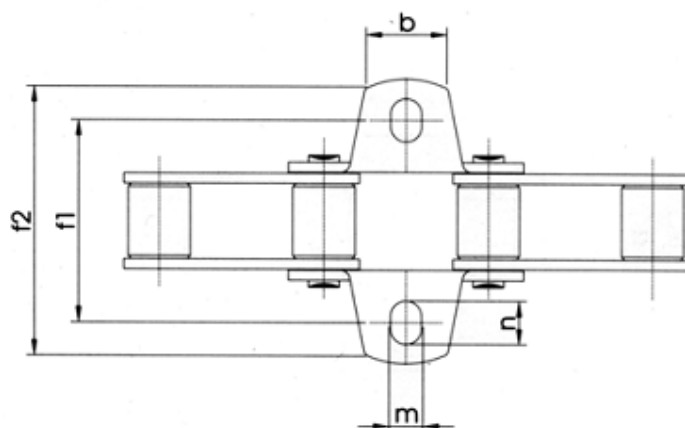
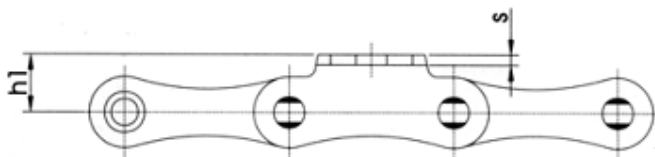

MODEL	TYP TYPE	p	g	m	b	h1	f1	f2
S42	K1	34,93	13,00	8,30	22,00	14,00	54,00	74,90

www.agro-tehnica.md
 mobil: 060187542 / 069120988
 email: cabacom.cad@gmail.com
 Adresa: Republica Moldova , Chisinau ,sos. Muncesti 56



S45

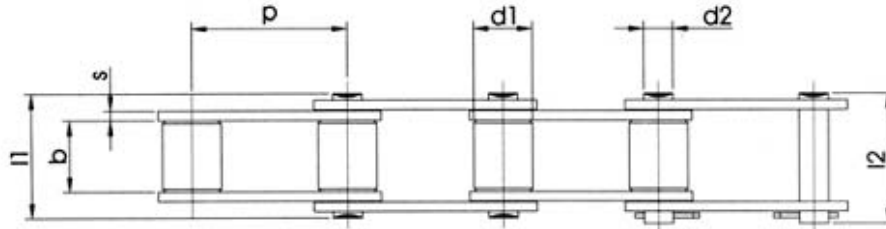
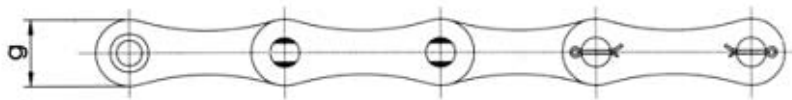

MODEL	p	b (min)	d1 (max)	d2	g	s	l1
S45	41,40	22,23	15,24	5,74	17,30	2,50	34,30

S45 ATTACHMENT CHAIN

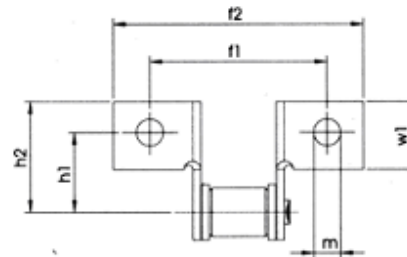
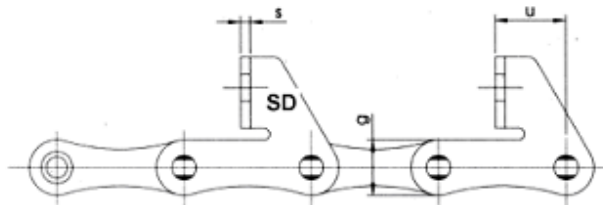
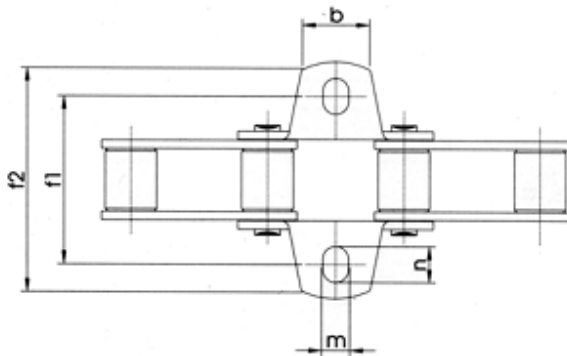
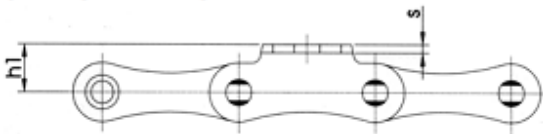

MODEL	TYP TYPE	p	s	g	m	n	B	h1	h2	f1	f2	u
S45	K1	41,40	2,5	17,30	8,30	6,30	29,00	11,40	-	54,00	74,90	-
S45	SD	41,40	2,5	17,30	6,40	-	-	16,00	26,00	58,00	88,50	24,00

S51

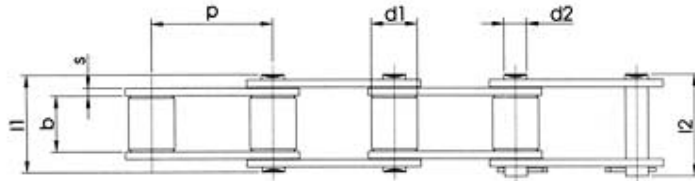
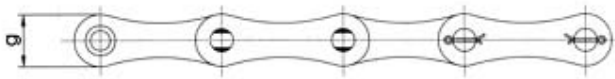

MODEL	p	b (min)	d1 (max)	d2	g	s	l1	l2
S51	38,10	15,88	15,24	5,72	17,30	2,40	30,00	32,30

S51 ATTACHMENT CHAIN

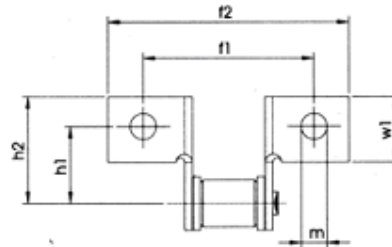
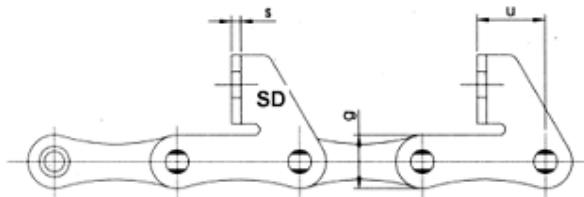
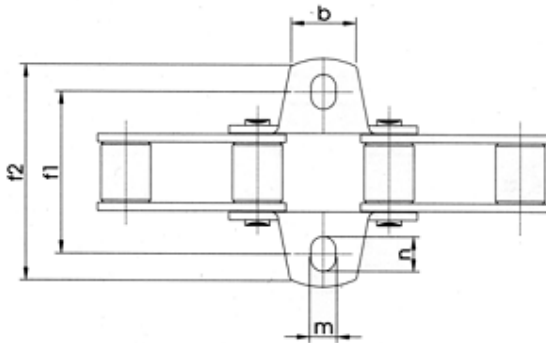
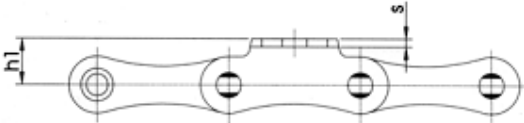

MODEL	TYP TYPE	p	s	g	m	n	b	h1	h2	f1	f2	u
S51	K1	38,10	2,50	17,30	10,10	8,50	-	11,40	-	49,80	68,00	-
S51	SD	38,10	2,50	17,30	6,50	-	-	19,00	29,00	54,40	80,00	28,70

www.agro-tehnica.md
 mobil: 060187542 / 069120988
 email: cabacom.cad@gmail.com
 Adresa: Republica Moldova , Chisinau ,sos. Muncesti 56



S52

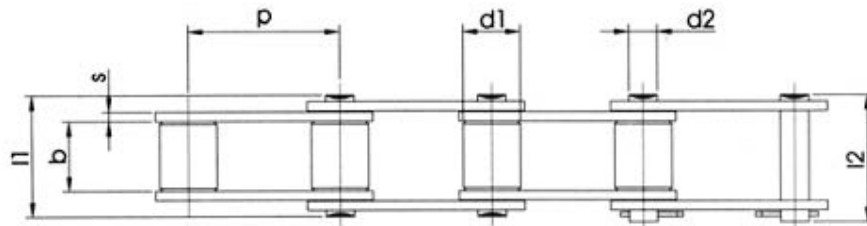
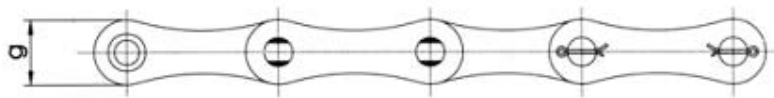

MODEL	p	b (min)	d1 (max)	d2	g	s	l1	l2
S52	38,10	22,23	15,24	5,72	17,30	2,40	38,10	40,65

S52 ATTACHMENT CHAIN

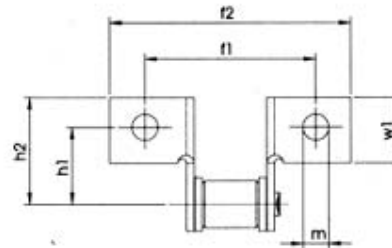
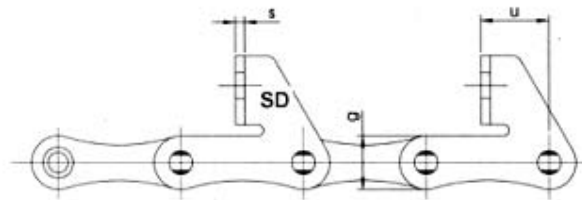
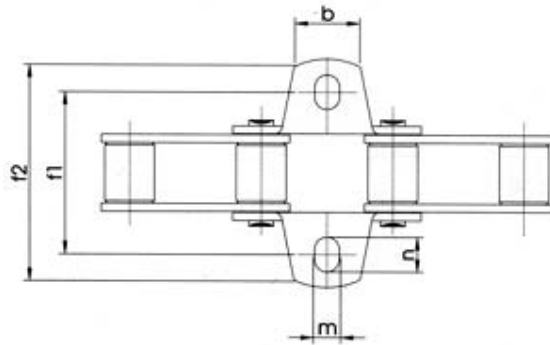
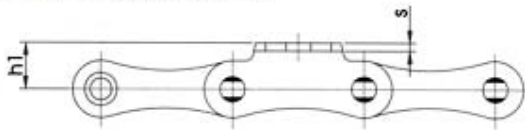

MODEL	TYP TYPE	p	s	g	m	n	b	h1	h2	f1	f2	u
S52	K1	38,10	2,50	17,30	10,10	8,50	-	11,40	-	58,80	77,50	-
S52	SD	38,10	2,50	17,30	6,50	-	-	19,00	29,00	62,00	89,20	28,70

S55

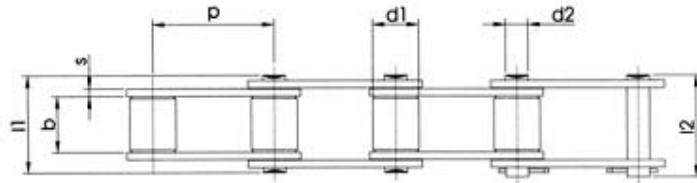
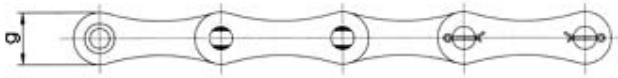

MODEL	p	b (min)	d1 (max)	d2	g	s	l1
S55	41,40	22,23	17,78	5,74	17,30	2,50	38,10

S55 ATTACHMENT CHAIN

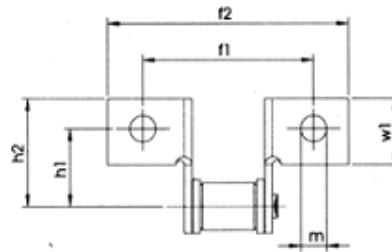
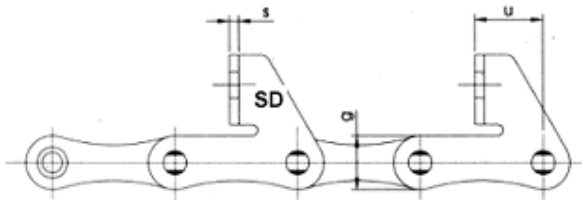
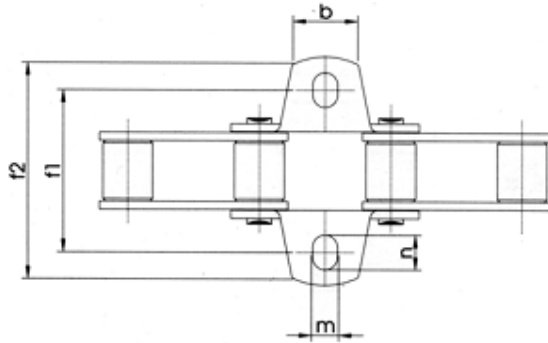
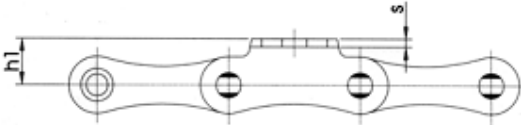

MODEL	TYP TYPE	p	s	g	m	n	b	H1	h2	F1	f2	u
S55	K1	41,40	2,5	17,30	11,50	8,30	29,00	11,40	-	54,00	74,90	-
S55	SD	41,40	2,5	17,30	6,40	-	-	16,00	26,00	58,00	88,50	24,00

S55R

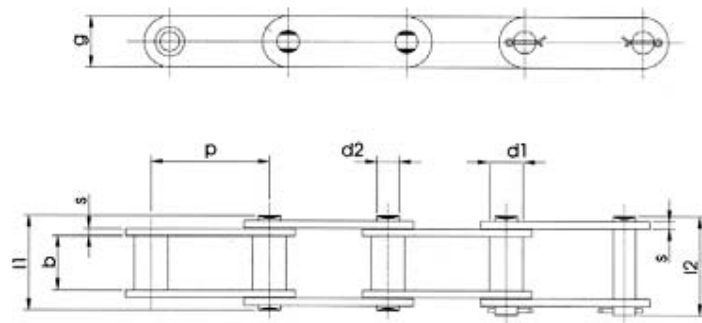

S55R OUTER MAIZE CHAIN

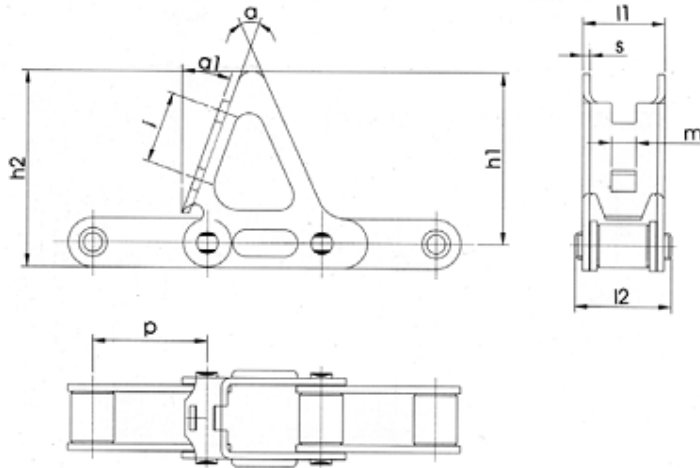

MODEL	p	s	m	h1	h2	l1	l2	A1	a	j
S55	41,40	3,00	8,10	58,00	69,00	35,40	39,50	45°	22,50°	22,00

S55V

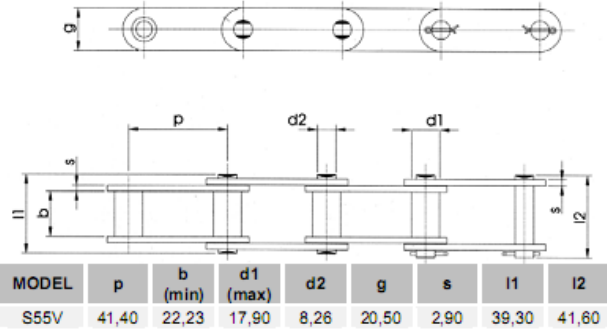

MODEL	p	b (min)	d1 (max)	d2	g	s	l1	l2
S55V	41,40	22,23	17,90	8,26	20,50	2,90	39,30	41,60

S55V ATTACHMENT CHAIN

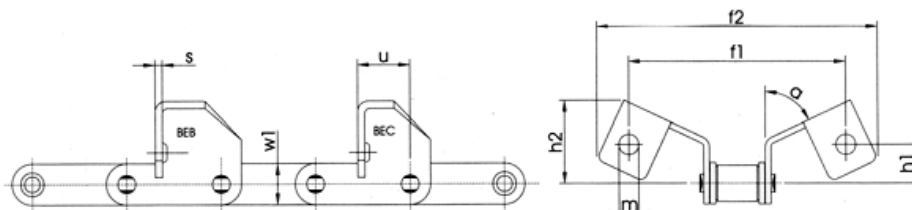

MODEL	TYP TYPE	p	s	m	u	h1	h2	f1	f2	a	w1
S55V	BEB F1	41,40	2,90	8,50	31,50	18,00	40,00	88,00	118,00	50°	20,50
S55V	BEC F1	41,40	2,90	8,50	19,00	18,00	40,00	88,00	118,00	50°	20,50

S55VD

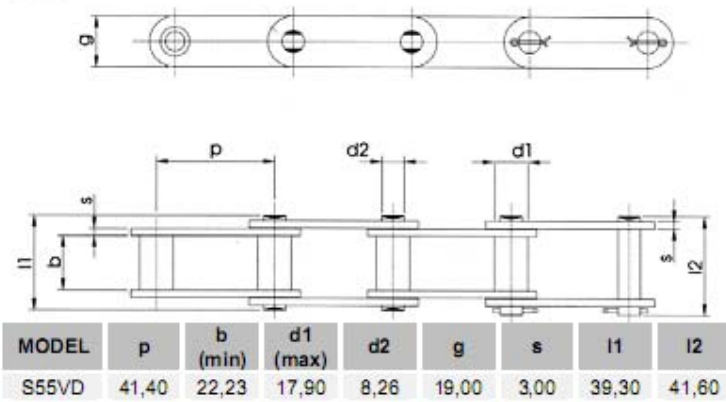

S55VD ATTACHMENT CHAIN

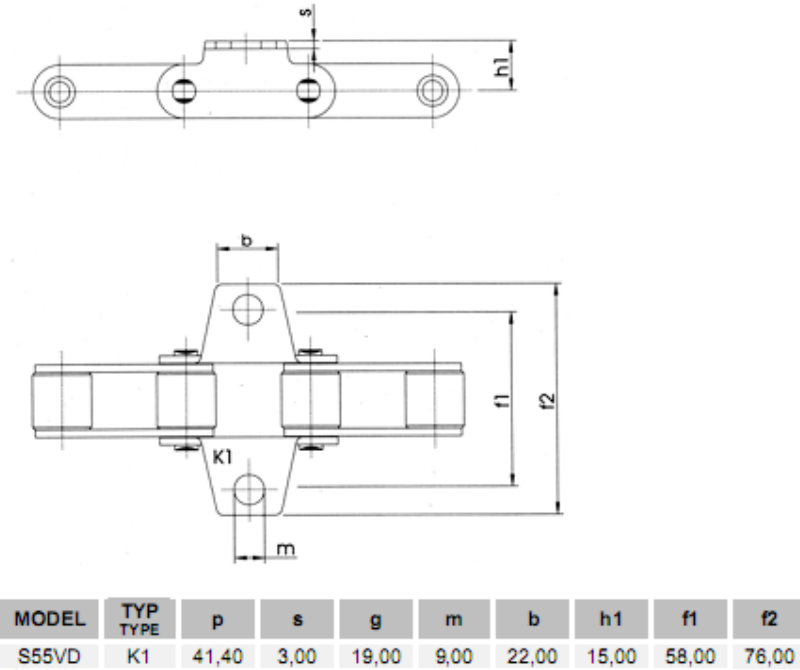

S62

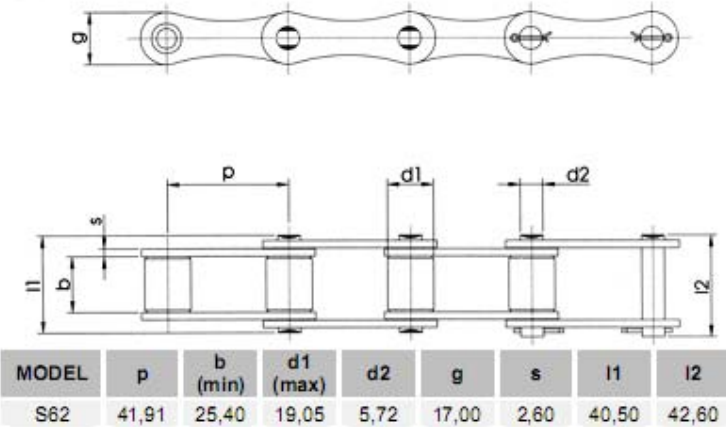

S62 ATACHMENT CHAIN

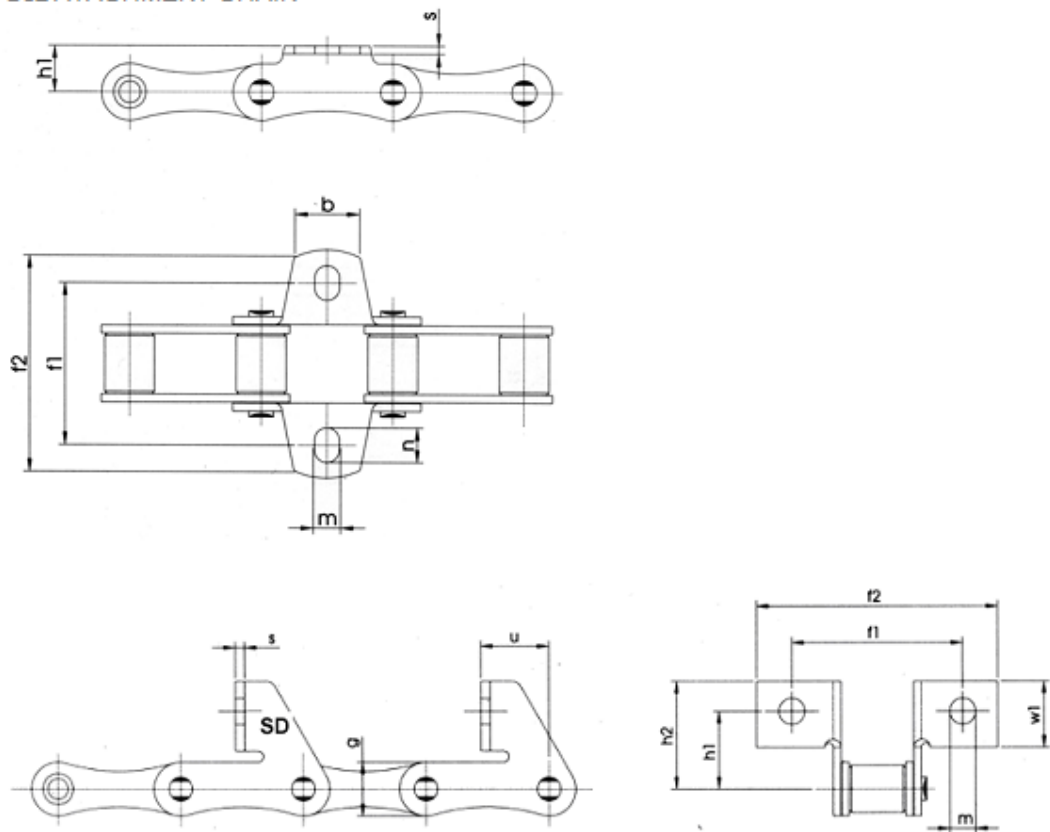

MODEL	TYP TYPE	p	s	g	m	n	b	H1	h2	f1	f2	u
S62	K1	41,40	2,5	17,30	8,30	14,70	26,00	11,40	-	66,65	95,30	-
S62	SD	41,40	2,5	17,30	6,40	-	-	19,00	26,00	58,00	88,50	24,00

S77

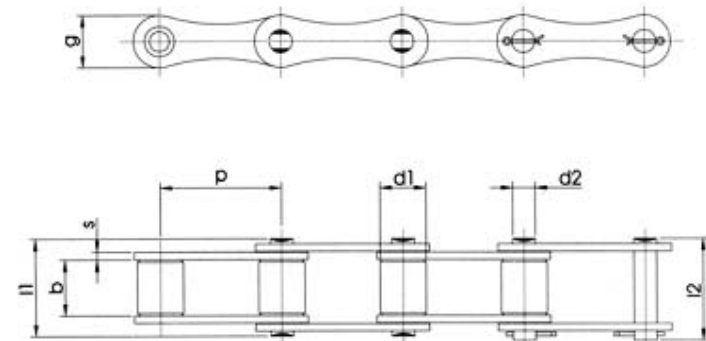

MODEL	p	b (min)	d1 (max)	d2	g	s	l1
S77	58,34	22,23	18,26	8,92	26,20	4,00	43,90

S77 ATTACHMENT CHAIN

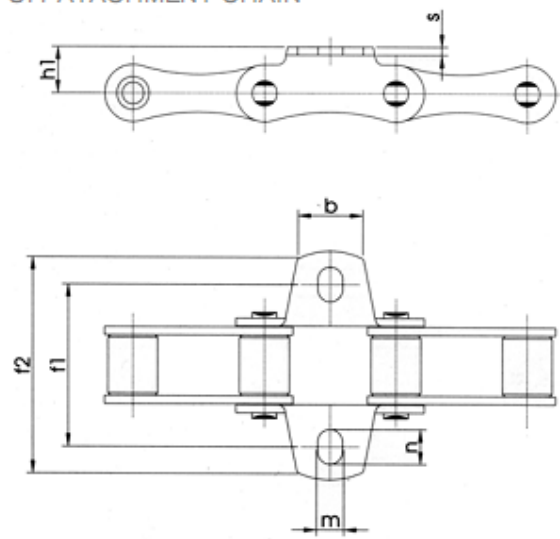

MODEL	TYP TYPE	p	s	g	m	n	b	h1	f1	f2
S77	K1	58,34	4,00	26,20	8,30	11,50	40,00	20,80	76,20	101,60

S88

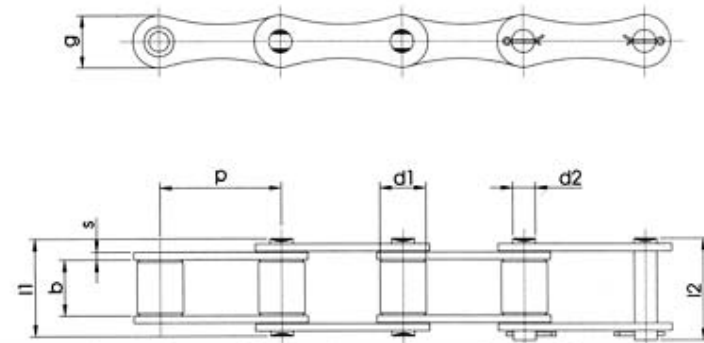

MODEL	p	b (min)	d1 (max)	d2	g	s	l1
S88	66,27	28,58	22,86	8,92	26,20	4,00	50,80



S88 ATTACHMENT CHAIN

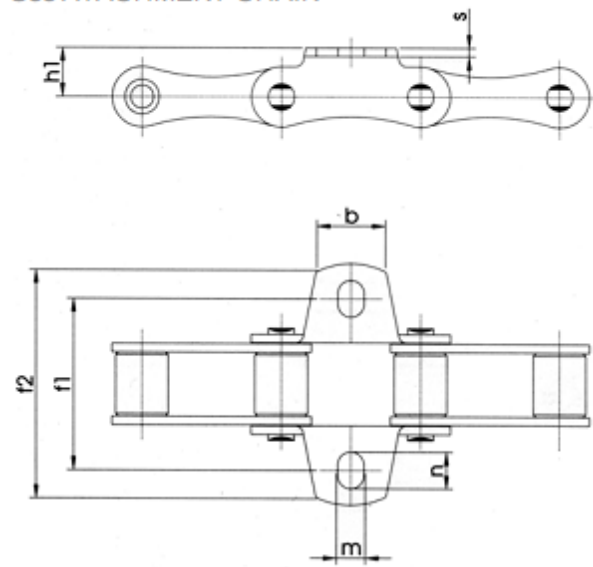

MODEL	TYP TYPE	p	s	g	m	n	b	h1	f1	f2
S88	K1	66,27	4,00	26,20	8,30	9,90	46,00	20,80	97,00	119,40

CA550

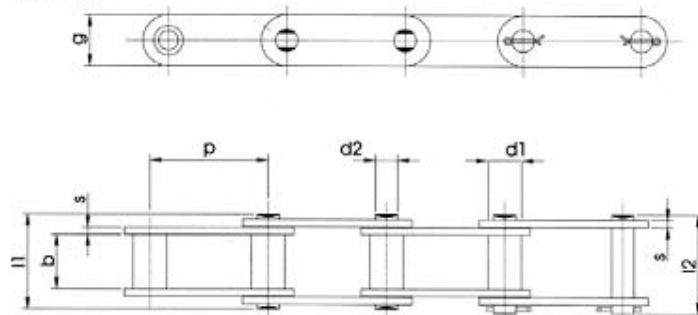

MODEL	p	b (min)	d1 (max)	d2	g	s	l1
CA550	41,40	20,20	16,87	7,19	20,20	2,70	35,60

CA550 ATTACHMENT CHAIN

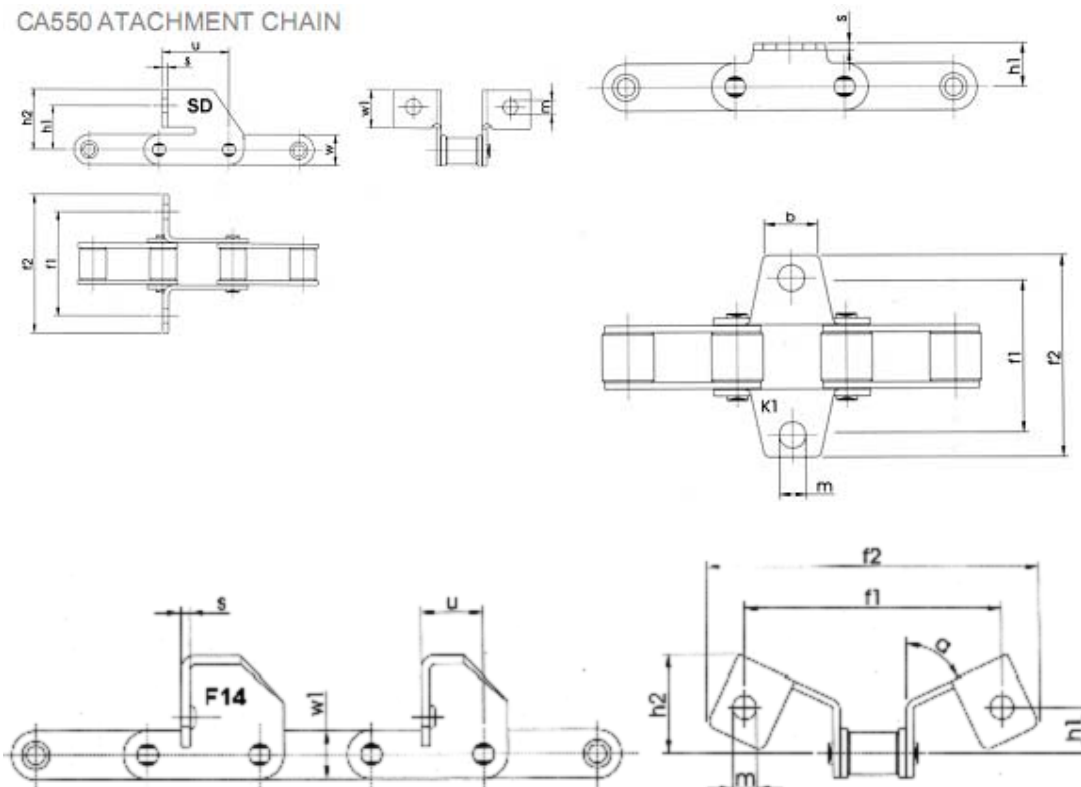

MODEL	TYP TYPE	p	s	g	m	b	h1	h2	f1	f2	u
CA550	K1	41,40	2,50	20,20	8,30	31,00	16,50	-	50,80	76,20	-
CA550	SD	41,40	2,70	20,20	8,70	-	31,00	42,90	47,60	68,20	38,10
CA550	F14	41,40	2,80	-	10,30	-	15,70	-	79,20	107,00	20,40

CA550 C6E OUTER MAIZE CHAIN

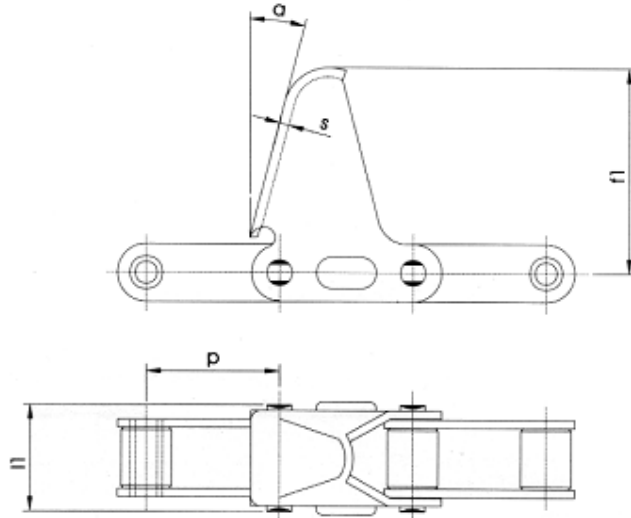

MODEL	TYP TYPE	p	s	a	l1	f1
CA550	C6E	41,40	2,60	22,50°	55,60	55,60

CA550 C11E OUTER MAIZE CHAIN

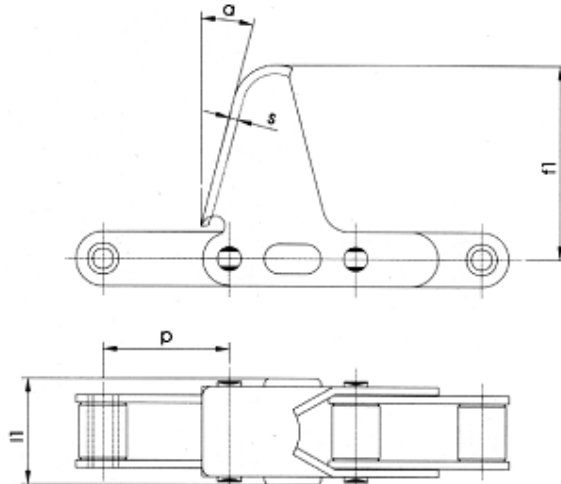

MODEL	TYP TYPE	p	s	a	l1	f1
CA550	C11E	41,40	2,60	15,00°	34,80	63,50

CA555

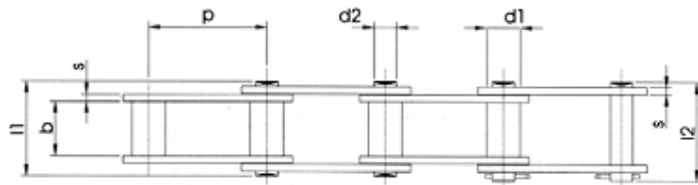
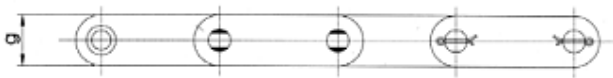

MODEL	p	b (min)	d1 (max)	d2	g	s	l1
CA555	41,40	12,70	16,70	7,19	20,00	3,10	33,50

CA555 OUTER MAIZE CHAIN

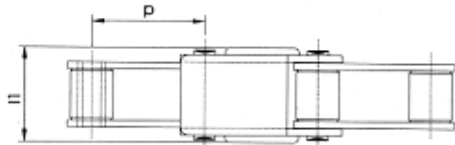
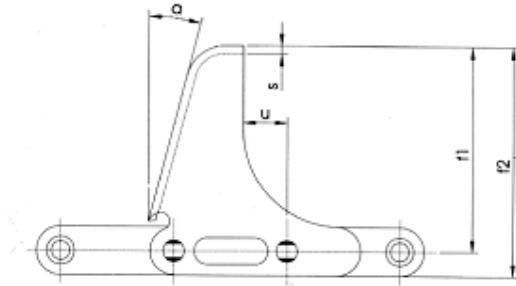

MODEL	TYP TYPE	p	s	a	l1	f1	f2
CA555	C6E	41,40	3,24	15,00°	32,08	63,50	73,00

CA557

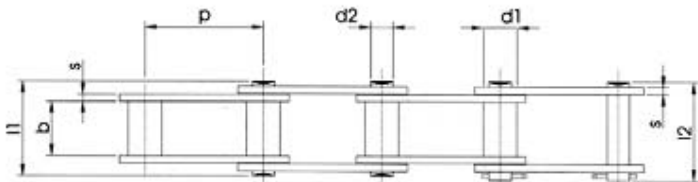

MODEL	p	b (min)	d1 (max)	d2	g	s	l1	l2
CA557	41,40	19,05	17,75	7,99	22,30	2,70	35,60	38,20

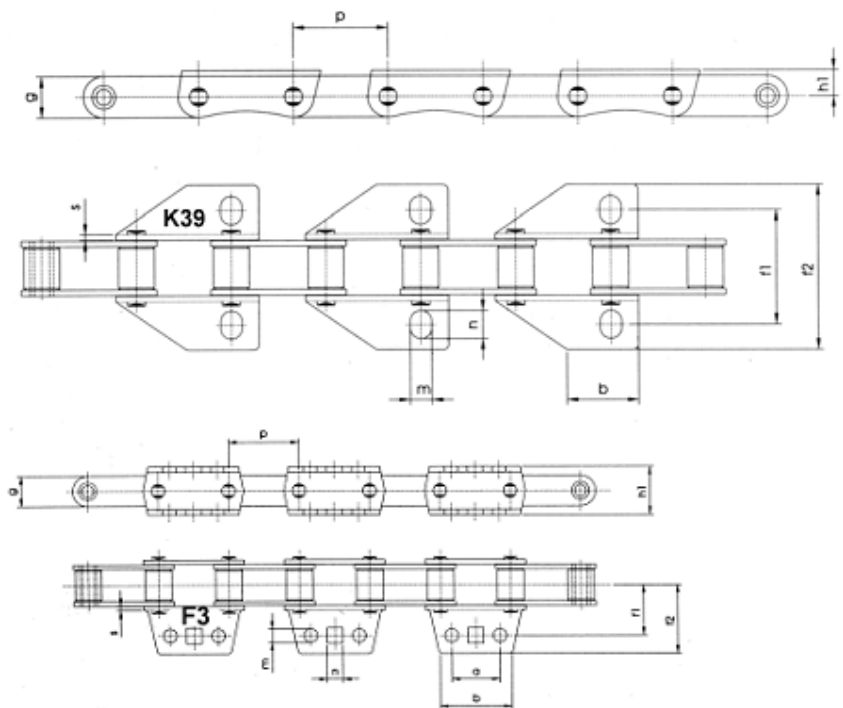

MODEL	TYP TYPE	p	s	g	m	n	h1	h2	f1	f2	a	b
CA557	K39	41,40	2,90	22,00	10,00	-	12,70	-	53,85	78,00	-	-
CA557	F3	41,40	2,90	22,00	8,20	9,73	31,00	42,90	31,90	43,30	30,20	35,00

CA2801

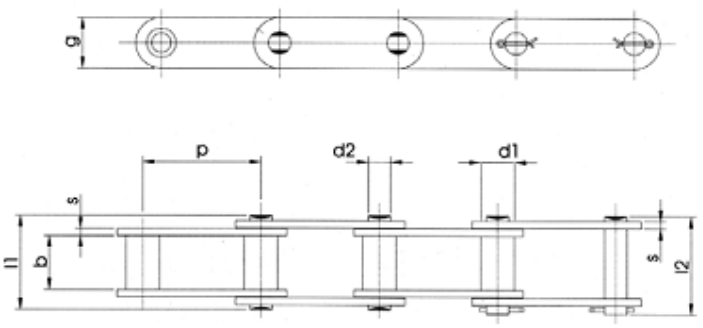

MODEL	p	b (min)	d1 (max)	d2	g	s	l1	l2
CA2801	30,00	19,05	15,88	8,26	20,50	2,90	35760	39,27



CA2801 OUTER MAIZE CHAIN

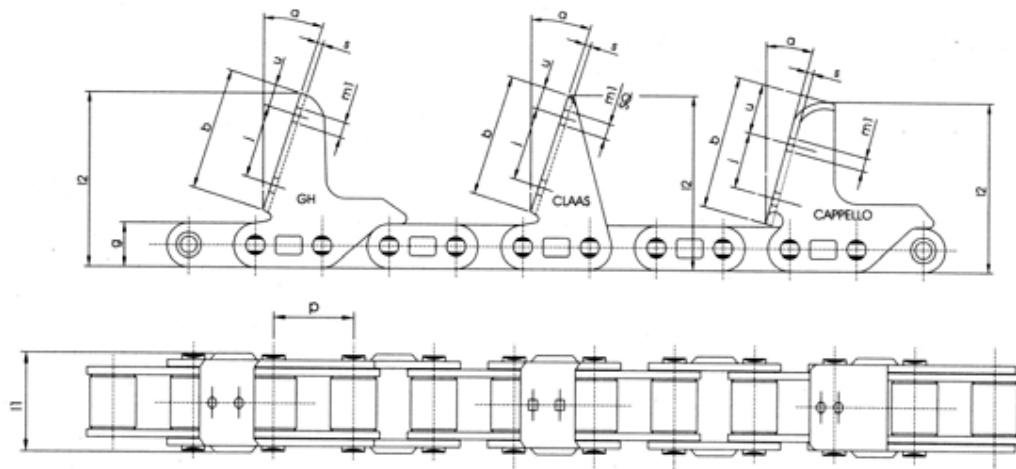

MODEL	TYP TYPE	p	s	g	m1	u	J	l1	l2	a	b
CA2801 TM90	GERRINGHOFF	30,00	2,90	20,50	6,00	8,80	30,00	36,60	73,75	22,50°	50,00
CA2801 TM92	CLAAS	30,00	2,90	20,50	6,60	8,80	30,00	36,60	74,00	22,50°	50,00
CA2801	CAPPELLO	30,00	2,90	20,50	6,00	8,80	25,50	36,60	73,50	15,00°	58,00

CA2801 INNER MAIZE CHAIN

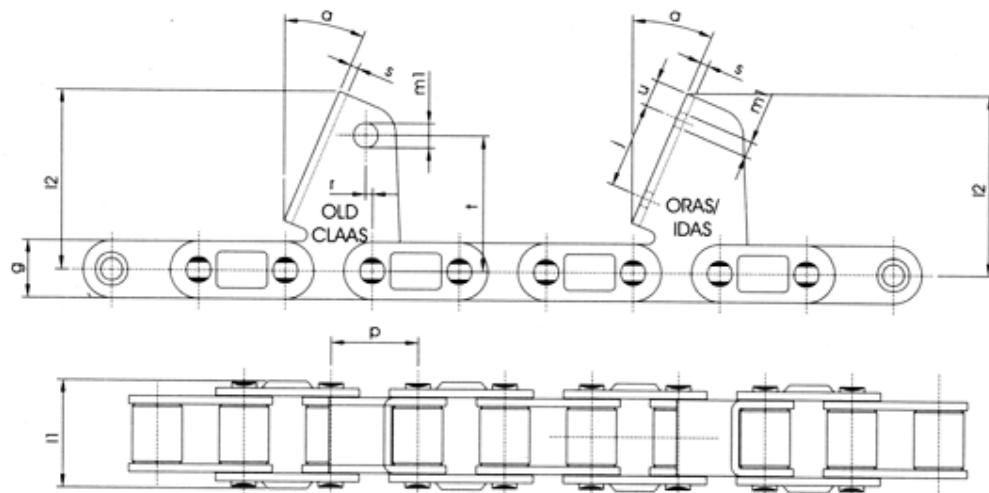

MODEL	TYP TYPE	p	s	g	m1	u	j	l1	l2	a	t	r
CA2801	CLAAS STARY TYP	30,00	2,90	20,50	8,50	-	-	36,60	63,50	22,50°	47,50	2,25
CA2801	OROS/IDAS	30,00	2,90	20,50	5,00	9,45	30,00	36,60	63,50	22,50°	-	-

CA2060

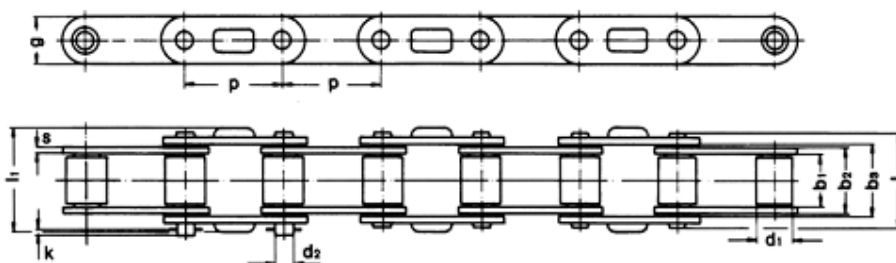

MODEL	p	b1	b2	b3	d1	d2	g	k	s	l	l1
CA2060	38,10	12,70	19,40	20,00	11,90	5,95	18,10	2,20	3,10	28,60	31,00

CA2060 OUTER MAIZE CHAIN

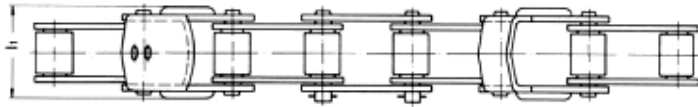
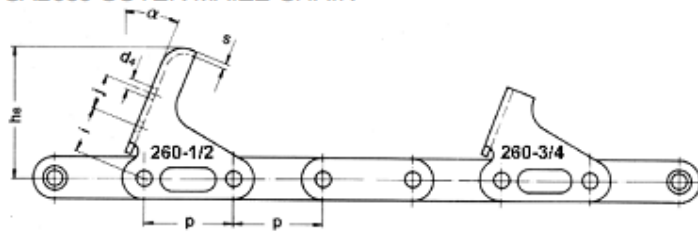

MODEL	TYP TYPE	p	s	g	d4	h8	α	l	j	l1	s
CA2060	260-1 bez ctw.	38,10	3,10	18,10	-	63,50	22°	-	-	31,00	3,10
CA2060	260-2 z ctw.	38,10	3,10	18,10	6,75	63,50	22°	23,80	25,40	31,00	3,10
CA2060	260-3 bez ctw.	38,10	3,10	18,10	-	57,00	22°	-	-	31,00	3,10
CA2060	260-4 z ctw.	38,10	3,10	18,10	6,75	57,00	22°	23,80	25,40	31,00	3,10

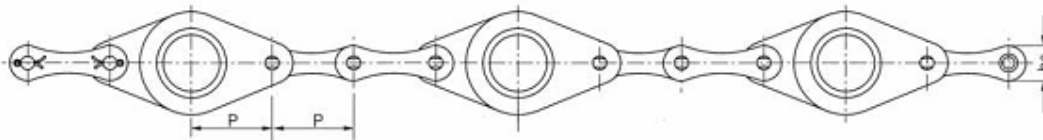

MODEL	p	b1	d1	d2	d3	h2	L1	L2	LC
216BF	50,8	17,02	17,02	8,28	35,3	22,0	37,8	35,8	41,3

208A 208B 210A 210B 212A 212B

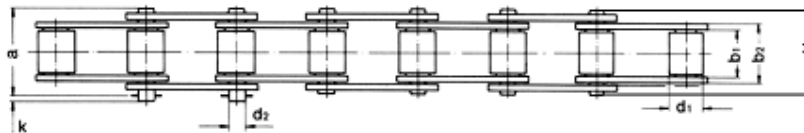
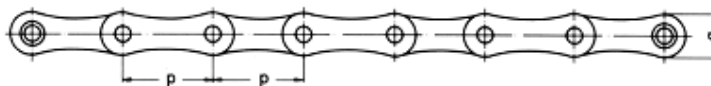

MODEL	p	b1	b2	a	d1	d2	g	k	l1
208A	25,4	7,75	11,30	17,00	8,51	4,45	11,81	3,90	16,80
208B	25,4	7,95	11,18	17,80	7,92	3,96	12,00	3,90	16,90
210A	31,75	9,53	13,84	21,80	10,16	5,08	15,09	4,10	20,60
210B	31,75	9,85	-	-	10,16	5,08	14,26	4,10	19,50
212A	38,10	12,70	19,40	28,60	11,90	5,94	18,00	2,20	25,60
212B	38,10	11,70	-	-	12,07	5,72	16,00	2,20	22,20

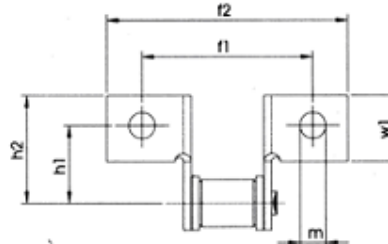
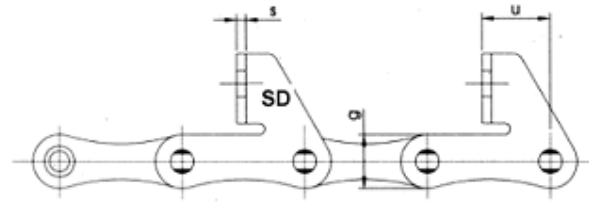
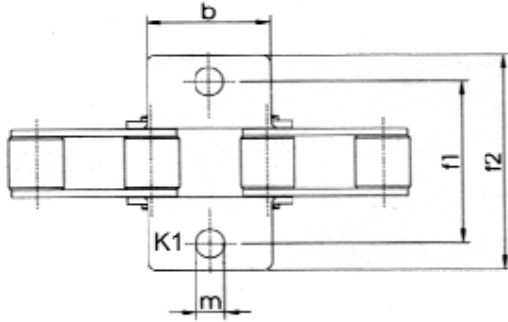
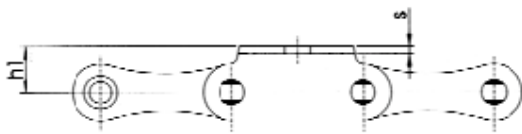

MODEL	TYP TYPE	p	s	g	m	b	h1	h2	f1	f2	u
210B	K1	31,75	1,82	14,73	5,30	23,80	10,67	-	31,75	43,10	-
212B	SD	38,10	3,17	16,13	6,40	-	-	-	-	-	-

04B + 56B

B-1

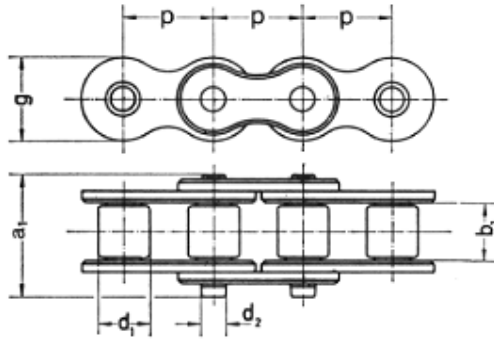

MODEL	p	b1	d1	d2	g	a1
04B-1	6,00	2,80	4,00	1,85	5,00	9,90
05B-1	8,00	3,00	5,00	2,31	7,10	11,70
06B-1	9,525	5,72	6,35	3,28	8,20	16,80
08B-1	12,70	7,75	8,51	4,45	11,80	19,00
10B-1	15,875	9,65	10,16	5,08	14,70	20,50
12B-1	19,05	11,68	12,07	5,72	16,10	24,20
12B-1H	19,05	11,68	12,07	6,10	16,10	27,50
16B-1	25,4	17,02	15,88	8,28	21,00	39,40
20B-1	31,751	19,56	19,05	10,19	26,40	43,60
24B-1	38,10	25,40	25,40	14,63	33,40	57,80
28B-1	44,45	30,99	27,94	15,90	37,00	67,80
32B-1	50,80	30,99	29,21	17,81	42,20	70,10
40B-1	63,50	38,10	39,37	22,89	52,90	85,80
48B-1	76,20	45,72	48,26	29,24	63,80	106,30
56B-1	88,90	53,34	43,34	53,98	34,32	77,80

B-2

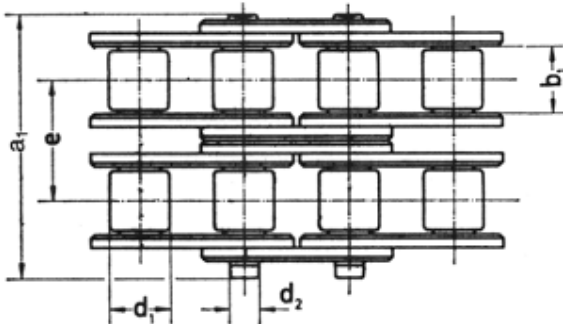

MODEL	p	b1	d1	d2	g	e	a1
06B-2	9,525	5,72	6,35	3,28	8,20	10,24	27,10
08B-2	12,70	7,75	8,51	4,45	11,80	13,92	33,20
10B-2	15,875	9,65	10,16	5,08	14,70	16,59	37,50
12B-2	19,05	11,68	12,07	5,72	16,10	19,46	43,90
16B-2	25,4	17,02	15,88	8,28	21,00	31,88	71,90
20B-2	31,751	19,56	19,05	10,19	26,40	36,45	80,30
24B-2	38,10	25,40	25,40	14,63	33,40	48,36	106,00
28B-2	44,45	30,99	27,94	15,90	37,00	59,56	129,00
32B-2	50,80	30,99	29,21	17,81	42,20	58,55	129,10
40B-2	63,50	38,10	39,37	22,89	52,90	72,29	158,50
48B-2	76,20	45,72	48,26	29,24	63,80	91,21	198,00
56B-2	88,90	53,34	43,34	53,98	34,32	106,6	229,50

B-3

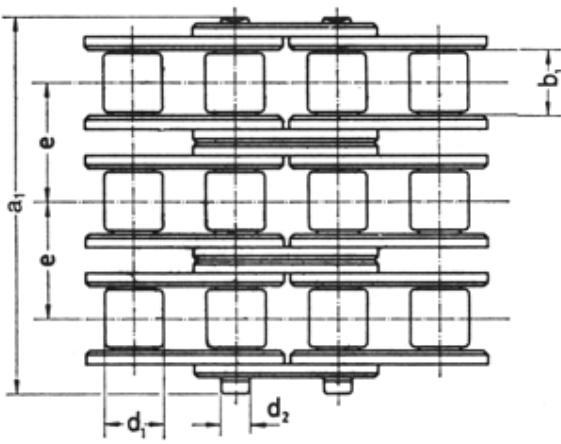

MODEL	p	b1	d1	d2	g	e	a1
06B-3	9,525	5,72	6,35	3,28	8,20	10,24	37,30
08B-3	12,70	7,75	8,51	4,45	11,80	13,92	47,20
10B-3	15,875	9,65	10,16	5,08	14,70	16,59	54,10
12B-3	19,05	11,68	12,07	5,72	16,10	19,46	63,50
16B-3	25,4	17,02	15,88	8,28	21,00	31,88	103,90
20B-3	31,751	19,56	19,05	10,19	26,40	36,45	116,80
24B-3	38,10	25,40	25,40	14,63	33,40	48,36	155,50
28B-3	44,45	30,99	27,94	15,90	37,00	59,56	188,80
32B-3	50,80	30,99	29,21	17,81	42,20	58,55	189,00
40B-3	63,50	38,10	39,37	22,89	52,90	72,29	230,80
48B-3	76,20	45,72	48,26	29,24	63,80	91,21	289,50
56B-3	88,90	53,34	43,34	53,98	34,32	106,6	336,80

35A + 200A

A-1

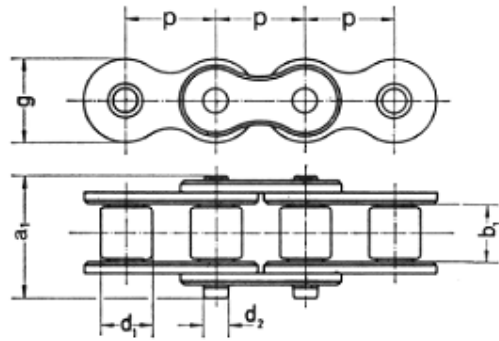

MODEL	ANSI	p	b1	d1	d2	g	a1
35A-1	06A-1	9,525	4,77	5,08	3,59	8,30	12,00
40A-1	08A-1	12,70	7,95	7,92	3,96	11,80	18,30
50A-1	10A-1	15,875	9,53	10,16	5,08	15,00	22,20
60A-1	12A-1	19,05	12,70	11,91	5,94	18,00	27,4
60A-1H	12A-1H	19,05	12,70	11,91	5,94	18,00	38,70
80A-1	16A-1	25,40	15,88	15,88	7,92	24,00	36,80
80A-1H	16A-1H	25,40	15,88	15,88	7,92	24,00	47,30
100A-1	16A-1	31,75	19,05	19,05	9,53	30,00	43,60
100A-1H	16A-1H	31,75	19,05	19,05	9,53	30,00	56,20
120A-1	20A-1	38,10	25,40	22,23	11,10	36,00	54,70
120A-1H	20A-1H	38,10	25,40	22,23	11,10	36,00	67,20
140A-1	28A-1	44,45	25,40	25,40	12,70	42,00	58,50
140A-1H	28A-1H	44,45	25,40	25,40	12,70	42,00	72,80
160A-1	32A-1	50,80	31,75	28,58	14,27	48,00	68,40
160A-1H	32A-1H	50,80	31,75	25,58	14,27	48,00	83,30
200A-1	40A-1	63,50	38,10	39,68	19,84	58,00	84,20

A-2

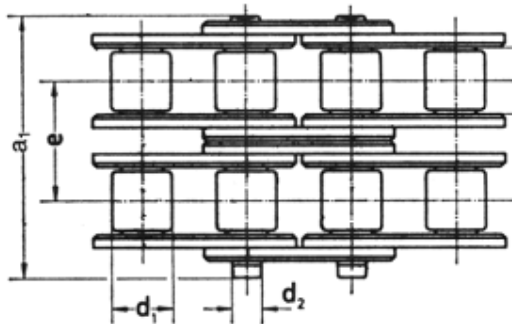

MODEL	ANSI	p	b1	d1	d2	g	e	a1
35A-2	06A-2	9,525	4,77	5,08	3,59	8,30	10,13	24,50
40A-2	08A-2	12,70	7,95	7,92	3,96	11,80	14,38	33,00
50A-2	10A-2	15,875	9,53	10,16	5,08	15,00	18,11	40,70
60A-2	12A-2	19,05	12,70	11,91	5,94	18,00	22,78	50,40
80A-2	16A-2	25,40	15,88	15,88	7,92	24,00	29,29	66,50
100A-2	16A-2	31,75	19,05	19,05	9,53	30,00	35,76	79,60
120A-2	20A-2	38,10	25,40	22,23	11,10	36,00	45,44	100,50
140A-2	28A-2	44,45	25,40	25,40	12,70	42,00	48,87	107,80
160A-2	32A-2	50,80	31,75	28,58	14,27	48,00	58,55	127,50
200A-2	40A-2	63,50	38,10	39,68	19,84	58,00	71,55	156,20

A-3

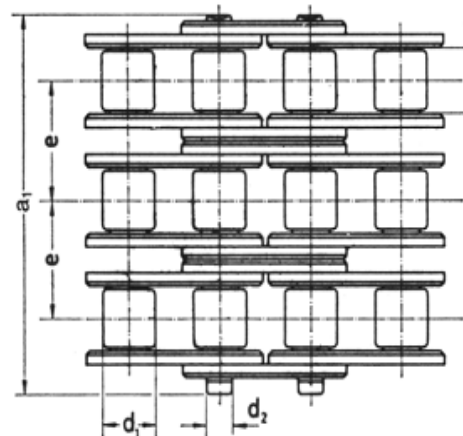

MODEL	ANSI	P	b1	d1	d2	g	e	a1
35A-3	06A-3	9,525	4,77	5,08	3,59	8,30	10,13	34,70
40A-3	08A-3	12,70	7,95	7,92	3,96	11,80	14,38	48,00
50A-3	10A-3	15,875	9,53	10,16	5,08	15,00	18,11	58,90
60A-3	12A-3	19,05	12,70	11,91	5,94	18,00	22,78	73,30
80A-3	16A-3	25,40	15,88	15,88	7,92	24,00	29,29	96,00
100A-3	16A-3	31,75	19,05	19,05	9,53	30,00	35,76	115,50
120A-3	20A-3	38,10	25,40	22,23	11,10	36,00	45,44	146,10
140A-3	28A-3	44,45	25,40	25,40	12,70	42,00	48,87	156,80
160A-3	32A-3	50,80	31,75	28,58	14,27	48,00	58,55	186,80
200A-3	40A-3	63,50	38,10	39,68	19,84	58,00	71,55	227,80

AGRICULTURAL CHAINS - TM ATTACHMENTS

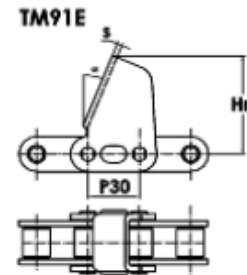
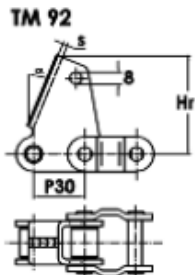
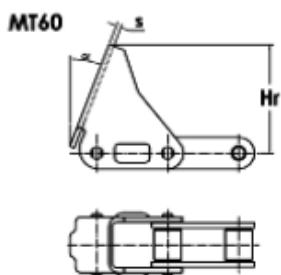
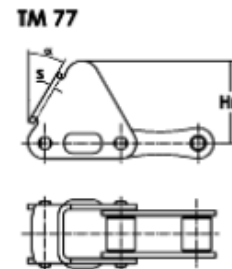
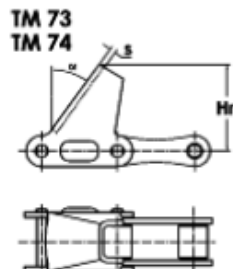
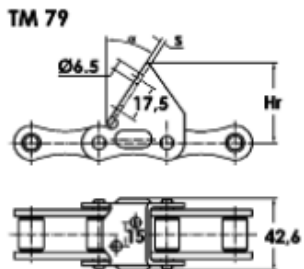
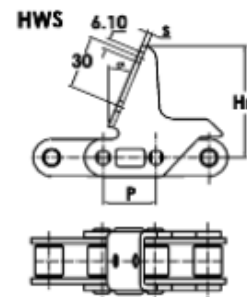
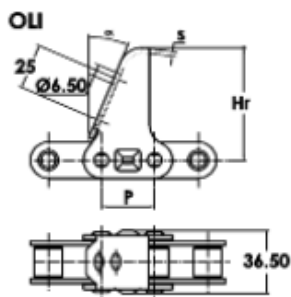
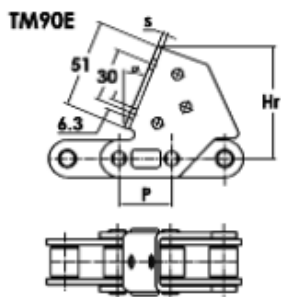

			p mm	α grad	Hr mm	s mm	Kg
•	CA2801	OLI	30,00	23,00	63,00	2,80	0,099
•	CA2801	HWS	30,00	22,00	63,85	2,80	0,113
•	CA2801	TM90E	30,00	22,50	62,50	2,80	0,159
•	CA2801	TM91E	30,00	22,50	62,50	2,80	0,130
•	CA2801	TM97E	30,00	22,50	57,50	2,80	0,124
•	CA624	TM92	38,40	20,00	64,50	3,00	0,150
•	CA643	TM73	41,40	36,00	56,00	3,00	0,138
•	CA643	TM77	41,40	28,00	51,50	3,10	0,138
•	CA645	TM73	41,40	36,00	56,00	3,00	0,138
•	CA645	TM77	41,40	28,00	51,50	3,10	0,138
•	CA646	TM74	41,40	36,00	72,50	3,10	0,161
•	CA646	TM79	41,40	37,00	49,50	2,80	0,094
•	CA646	TM73	41,40	36,00	51,40	3,00	0,138
•	CA414	MT60	41,40	20,00	66,00	3,00	0,150

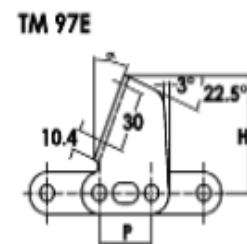

		p mm	α gradi	Hr mm	s mm	Kg
CL85R	CL85	41,40	22°30'	57,0	3,25	0,100
CL85R	CL97	41,40	22°30'	57,0	3,25	0,088
CL555	C6E	41,40	15°	63,5	2,80	0,075
CA620R	C15E-2	42,01	22°30'	59,5	3,00	0,105

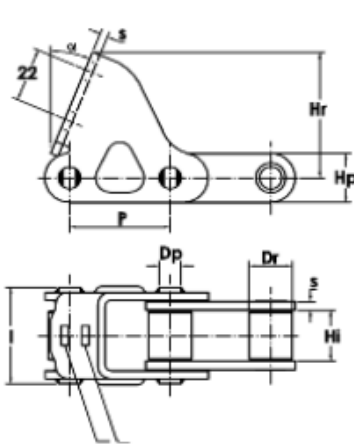
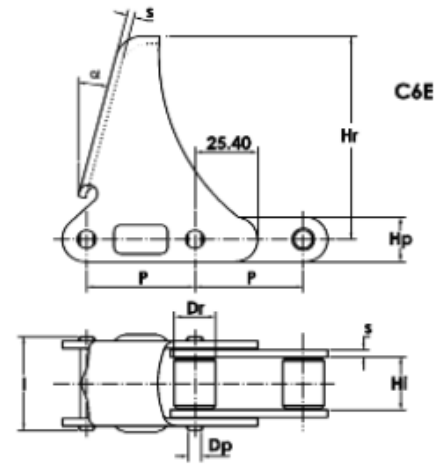

CL85

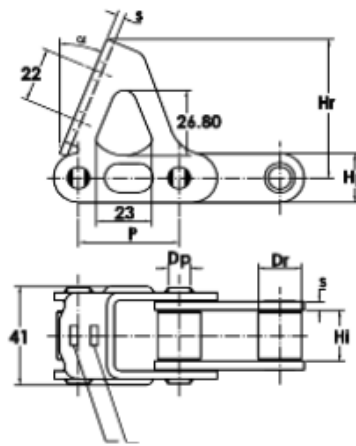

CL97

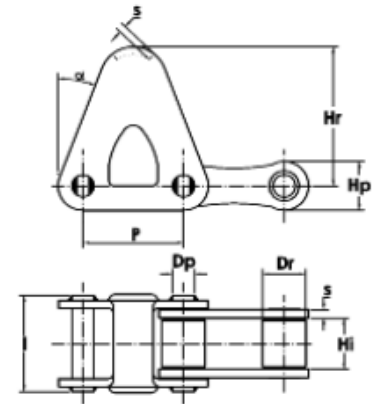

C15E-2

CORN PICKER CHAIN

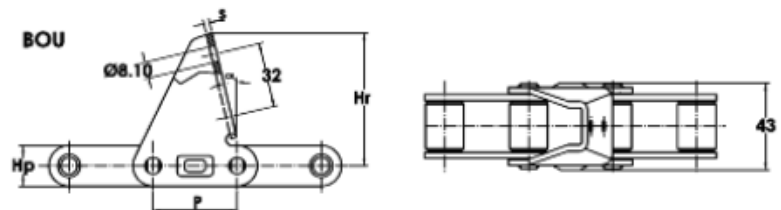

	P mm	Hi mm	Dr mm	Hp mm	Dp mm	l mm	lx mm	s mm	mm ²	Kg	Kg/m
• S62R	41,91	25,40	19,05	20,00	8,20	42	48,4	3	286	5,200	2,701